



3 Bedroom Terraced for Rent - £895 per month

Turton Road, Tottington, Bury, Lancs, BL8 4AW



KEY FEATURES

- ACCRINGTON BRICK TERRACED PROPERTY • ACCOMMODATION OVER THREE FLOORS • THREE BEDROOMS • GAS CENTRAL HEATING/DOUBLE GLAZING • TWO RECEPTION ROOMS • MODERN OPEN PLAN FITTED KITCHEN • EXTERNAL UTILITY ROOM • SEPARATE STUDIO WITH LIGHT AND POWER • PATIO GARDEN TO REAR • FULL INTERNAL RE-DECORATION

Description

**** A SPACIOUS AND WELL PRESENTED THREE BEDROOMED TERRACED PROPERTY LOCATED IN THE HEART OF TOTTINGTON VILLAGE. ACCOMMODATION OVER THREE FLOORS ****

New to the rental market is this spacious and well presented Accrington Brick terraced property with accommodation located over three floors.

Offering fabulous living accommodation with extras including attractive rear patio garden, off road parking to rear, outside utility and a great independent studio in the rear garden, the property offers modern, open plan living, located within the heart of Tottington Village Centre.

Undergoing a full programme of decoration throughout, the property is available for immediate viewing and tenancy from the 7th February 2022.

The accommodation in brief comprises of entrance hallway, lounge with feature fireplace, open plan second reception room housing second lounge area, dining area and modern kitchen with breakfast bar eating area. To the first floor, the property offers two good sized bedrooms and family bathroom fitted with three piece suite. The loft conversion provides a further room that could be utilised in various ways.

Outside, there is a small front patio garden. To the rear, the property offers stairs leading to decked area, outside utility with plumbing. The attractive patio garden leads to an off road parking area. In addition, the property offers an independent good sized studio/outside room with light and power.

Internal photographs are to follow. However, viewing can be arranged immediately through our Tottington office. The full programme of re-decoration will be complete within the next three weeks with tenancy commencement on the 7th February 2022.

19 Turton Road, Tottington

Approximate Gross Internal Area
1162 sq ft - 108 sq m

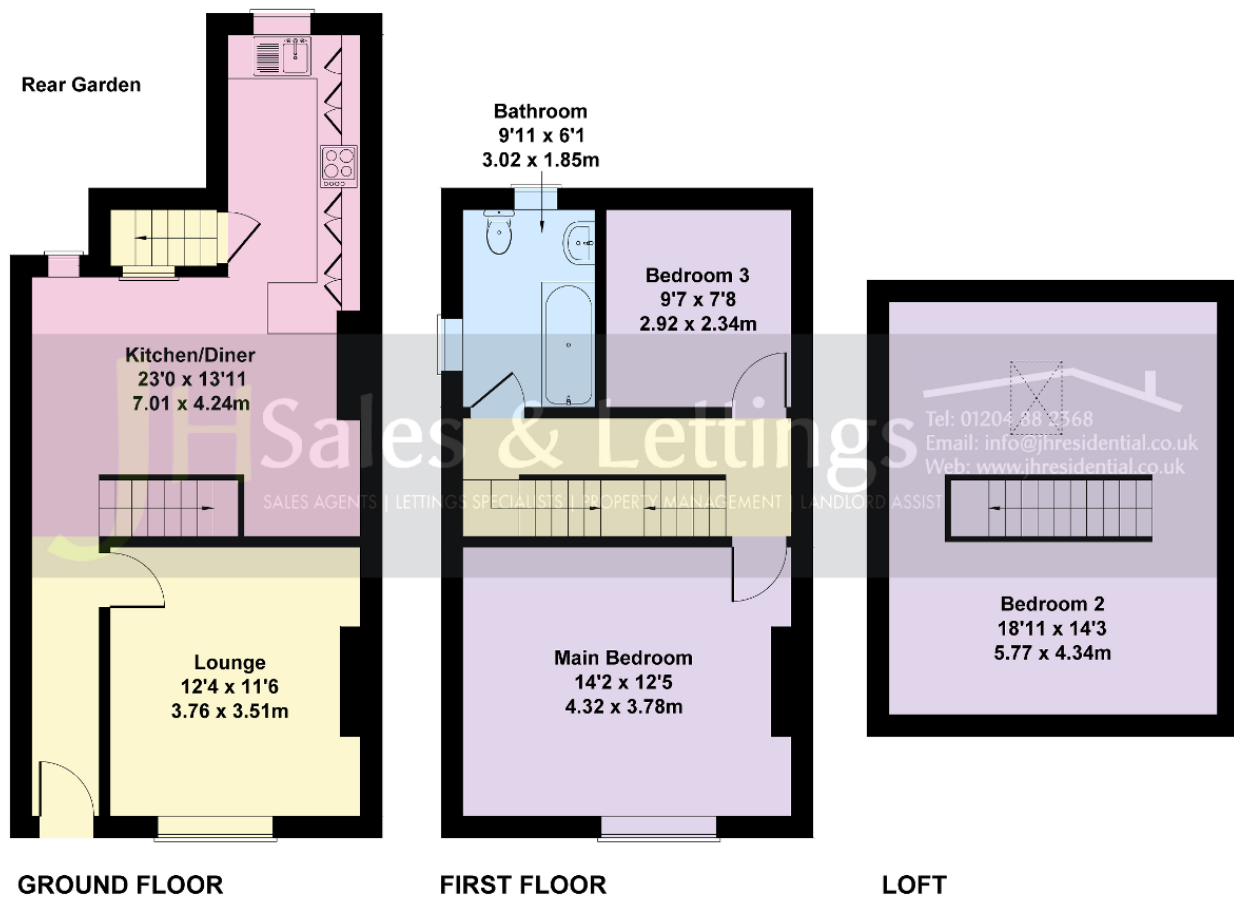

Not to Scale. Produced by The Plan Portal 2022
For Illustrative Purposes Only.

Energy Efficiency

Energy Efficiency Rating			
Score	Energy rating	Current	Potential
92+	A		
81-91	B		
69-80	C		72 C
55-68	D	59 D	
39-54	E		
21-38	F		
1-20	G		