

2 Bedroom Stone cottage for Rent - £695 per month

Quakersfield, Tottington, BL8 4AZ



KEY FEATURES

- ATTRACTIVE STONE COTTAGE • POPULAR LOCATION • LARGE LOUNGE WITH FEATURE FIREPLACE • MODERN FITTED KITCHEN • CONSERVATORY TO REAR • WELL PRESENTED THROUGHOUT • OPEN VIEWS TO FRONT ELEVATION • GAS CENTRAL HEATING • TWO BEDROOMS • AVAILABLE FOR VIEWING

Description

** A WELL PRESENTED TWO BEDROOMED STONE COTTAGE WITH VIEWS OVER SURROUNDING COUNTRYSIDE **

We are delighted to receive instructions to let this stone built traditional cottage located in the popular Quakersfield area of Tottington. With views over the surrounding countryside, the property has been presented to a good standard throughout.

Retaining original features throughout and benefiting from gas fired central heating, the accommodation comprises of good sized dining kitchen with a modern range of wall and base units, large lounge area with feature fireplace with inset fire, conservatory, large master bedroom with views, second bedroom and three piece main bathroom suite.

Externally, the property has a small enclosed patio area to the rear and a small garden area to the front with views.

This is a great rental property is a quiet and picturesque location with local amenities on your doorstep.

The property is available for viewing from the 4th October 2021.

Please enquire at our offices for further details.

A holding deposit equivalent to one weeks rent is payable for this property (deducted off first months rent).





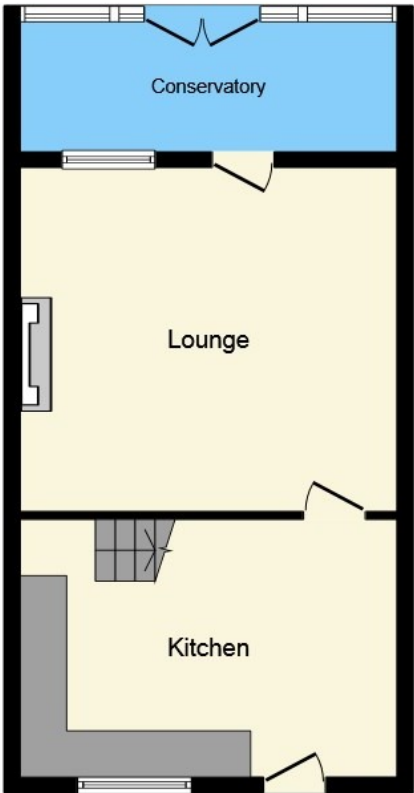

Ground Floor

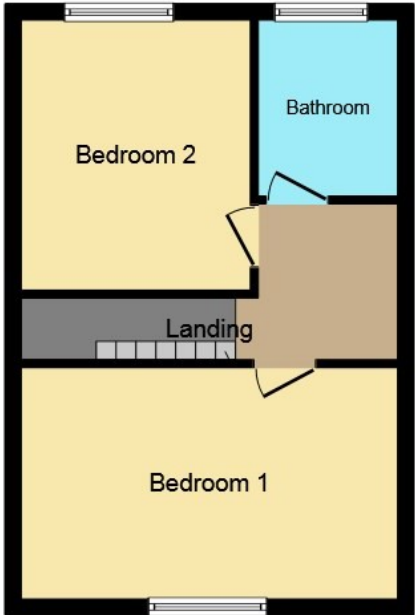

First Floor

Energy Efficiency

Energy Efficiency Rating			
Score	Energy rating	Current	Potential
92+	A		
81-91	B		
69-80	C		78 C
55-68	D		
39-54	E	52 E	
21-38	F		
1-20	G		