

## 2 Bedroom Terraced for Sale - Offers Over £115,000

Booth Street, Tottington, Bury, BL8 3JG



### KEY FEATURES

- IDEAL INVESTMENT OPPORTUNITY • MID TERRACED PROPERTY • POPULAR LOCATION • IN NEED OF REFURBISHMENT • TWO RECEPTION ROOMS • TWO DOUBLE BEDROOMS • LOFT CONVERSION • KITCHEN EXTENSION • ENCLOSED REAR YARD • IMMEDIATE VIEWING AVAILABLE



## Description

**\*\* A FANTASTIC OPPORTUNITY TO ACQUIRE THIS MID TERRACED PROPERTY IN NEED OF REFUBISHMENT. AN IDEAL INVESTMENT OPPORTUNITY OR ADDITION TO A RENTAL PORTFOLIO \*\***

VIEWINGS ARE AVAILABLE ON TUESDAY 5TH AND WEDNESDAY 6TH JANUARY 2021. THE PROPERTY WILL BE SUBJECT TO BEST AND FINAL OFFERS BY 6PM ON WEDNESDAY 6TH JANUARY 2021.

We are delighted to receive instructions to offer for sale this well proportioned mid terraced property located on the popular Booth Street in Tottington.

Offering excellent opportunity for further development, the property requires refurbishment throughout yet offers excellent living accommodation. Heated with gas fired central heating and having partial double glazing, the accommodation comprises of entrance hallway, lounge, second large reception room and kitchen extension to ground floor. To the first floor, the property has hallway, two double bedrooms and main family bathroom. There is the addition of a loft conversion, fitted with storage and velux windows to front and rear elevation.

Externally, there is a small front garden and an enclosed yard to the rear.

We expect interest to be high and the property is now available for viewing appointments.

Please contact our Tottington office for further details.

### Fixtures and Fittings

All fixtures and fittings to the property are by negotiation. The appliances and fittings have NOT been seen in working condition. The Agents are not competent to assess these areas. Interested parties are recommended to seek independent advice before committing themselves to purchase. Prospective purchases are advised to seek legal assistance to clarify the tenure, any boundaries or right of way prior to exchange of contrac







Floorplans

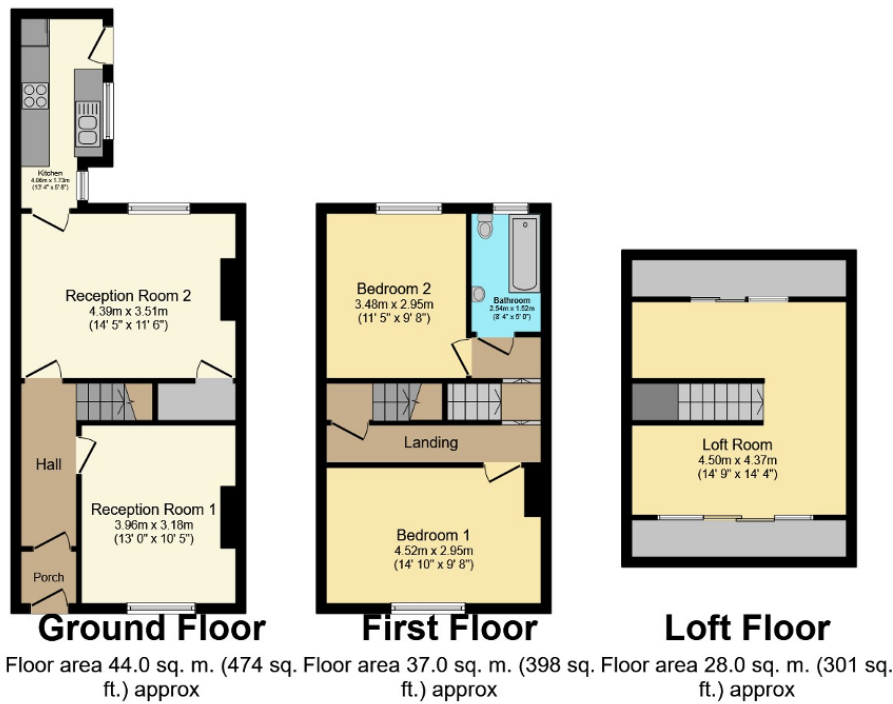

Total floor area 109.0 sq. m. (1,173 sq. ft.) approx

This Floor Plan is for illustration purposes only and may not be representative of the property. The position and size of doors, windows and other features are approximate. Unauthorized reproduction prohibited. © PropertyBOX

Energy Efficiency

