

## 2 Bedroom Terraced for Sale - £79,950

Schofield Street, Radcliffe, M26 2UQ



### KEY FEATURES

- MID TERRACED PROPERTY • FULL RENOVATION REQUIRED • POPULAR RESIDENTIAL AREA • IDEAL INVESTMENT OPPORTUNITY • TWO DOUBLE BEDROOMS • COVENIENT LOCATION • CLOSE TO METROLINK STATION • CLOSE TO MOTORWAY NETWORK • SOLD WITH NO ONWARD CHAIN

## Description

**\*\* A MID TERRACED PROPERTY REQUIRING FULL RENOVATION LOCATED IN POPULAR RESIDENTIAL AREA \*\***

JH Sales and Lettings have received instructions to offer for sale this two bedroom mid terraced property located in a popular area of Radcliffe with excellent rental/investment potential. Placed within easy access to all local amenities including nearby schools, shops and transport routes including the nearby motorway and Radcliffe Metrolink station is located a short walk away for onward travel.

The property is in need of a full programme of renovation although has the benefit of UPVC double glazing.

The accommodation comprises of entrance porch, lounge, good sized dining kitchen, separate utility room, two bedrooms and main bathroom. Outside, the property has a good sized rear yard area with walls to all sides and a small front garden. The property is available for immediate viewing and is sold with no onward chain.

### Accommodation:

Lounge: 15' x 13'11 (4.57m x 3.99m)

Dining Kitchen: 15' x 8'8 (4.57m x 2.68m)

Bedroom 1: 15' x 14' (4.57m x 4.26m)

Bedroom 2: 10'7 x 8'8 (3.26m x 2.68m)

Bathroom: 6'3 x 5'8 (1.92m x 1.76m)

### Fixtures and Fittings

All fixtures and fittings to the property are by negotiation. The appliances and fittings have NOT been seen in working condition. The Agents are not competent to assess these areas. Interested parties are recommended to seek independent advice before committing themselves to purchase. Prospective purchases are advised to seek legal assistance to clarify the tenure, any boundaries or right of way prior to exchange of contracts.

Interested parties should contact our offices in Tottington.



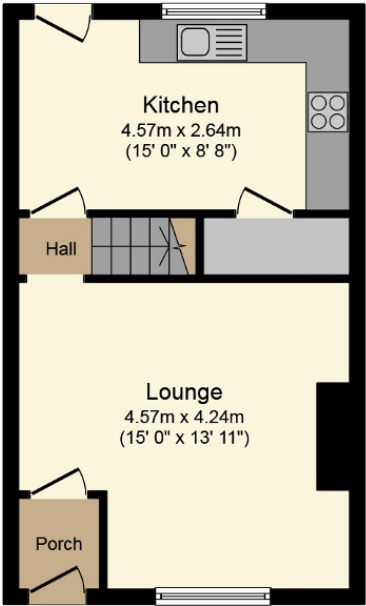

Ground Floor

Floor area 36.0 sq. m. (388 sq. ft.) approx

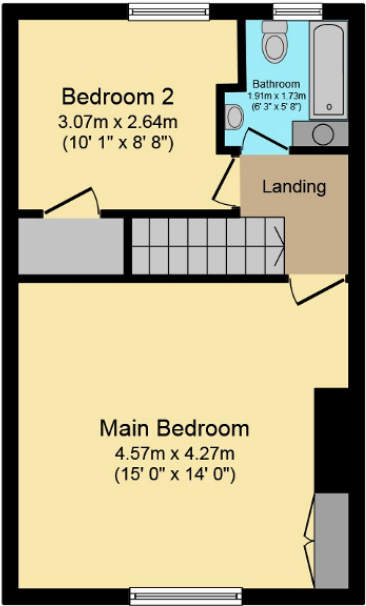

First Floor

Floor area 36.0 sq. m. (388 sq. ft.) approx

Total floor area 72.0 sq. m. (775 sq. ft.) approx

This Floor Plan is for illustration purposes only and may not be representative of the property. The position and size of doors, windows and other features are approximate. Unauthorized reproduction prohibited. © PropertyBOX

Energy Efficiency

Energy Efficiency Rating			
Score	Energy rating	Current	Potential
92+	A		
81-91	B		
69-80	C		77   C
55-68	D		
39-54	E		
21-38	F		
1-20	G	17   G	